

EF TAPPING VALVE

04 Update - 05/2024

TECHNICAL DATA

Article No	001 117 2072 0330
d (mm)	315
d1 (mm)	32
le (mm)	74
h (mm)	349
h1 (mm)	240
Z (mm)	126
L (mm)	160
Weight (Kg)	3,030
Box Quantity (pcs)	5
Box Dimension (cm)	55x30x37,5

INJECTION MOULDED

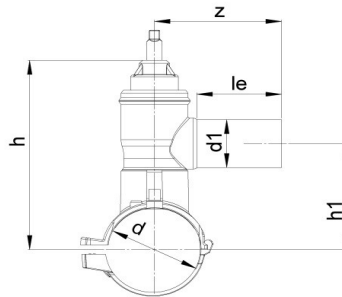

IDENTIFICATION OF PRODUCT

D(mm)	280-315x32
SDR	11
RAW MATERIAL	PE 100
PRESSURE CLASS	16 Bar Water
TRADEMARK	NTG
EXECUTION	Injection Moulded
STANDARD	EN 12201-3

EF SPECIFICATION

WELDING VOLTAGE	40 V
RESISTANCE	7.0 Ω
WELDING TIME	130 Sec.
COOLING TIME	15 Min.
WINDING TYPE	Monofilar

WELDING BARCODE



142007323153407005130113

SPECIFICATION

Suitable for SDR11....17 pipe
 4 mm pin connectors
 Long fusion outlet
 Opening on the spanner is 18 turns
 Wrench 12 mm
 The valve is closed clockwise

Tolerance on diameters and thickness according to the standards. The other dimensions are specialized. Tolerance ± 5%. NTG PLASTIK reserves all the right to change any information without giving prior notice. The production, distribution and utilization of this document without explicit authorization is prohibited.